

GLOWSPOT ECLIPSE 750 HD

www.lbtpro.com / info@lbtpro.com

- Colour Temperature
3200K / 5600K
- 26° Manual Zoom
- IP20
- 250W Max Power



Specifications

◆ Color Rendering	> 90Ra	> 90Ra
◆ Driver Current	3.3A	3.3A
◆ Max Power	250W	250W
◆ Control Personality	UNO,DOS,STD.P 1CH2CHS,3CHS	UNO,DOS,STD.P 1CH2CHS,3CHS
◆ Optics	26°(5° 10°,19°, 36°, 50°, 15°-30°, 25°-50°Optional)	26°(5° 10°,19°, 36°, 50°, 15°-30°, 25°-50°Optional)
◆ Color Temperature	3200K	5600K
◆ Dimensions	720X380X340mm	720X380X340mm
◆ Weight	9.6kg(with lens barrel)	9.6kg(with lens barrel)
◆ Housing	Die-cast aluminium	Die-cast aluminium
◆ Color	Black	Black
◆ Environment	Dry	Dry

Dimension

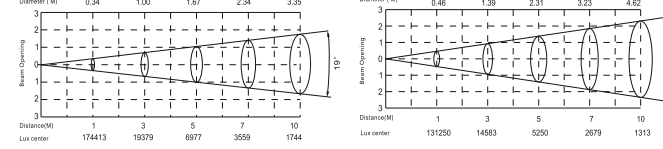
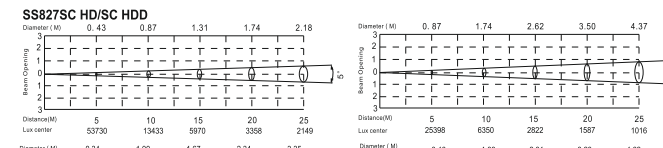
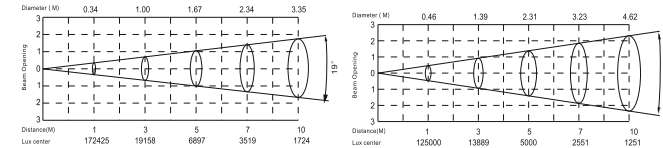
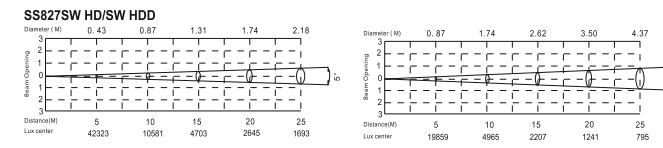
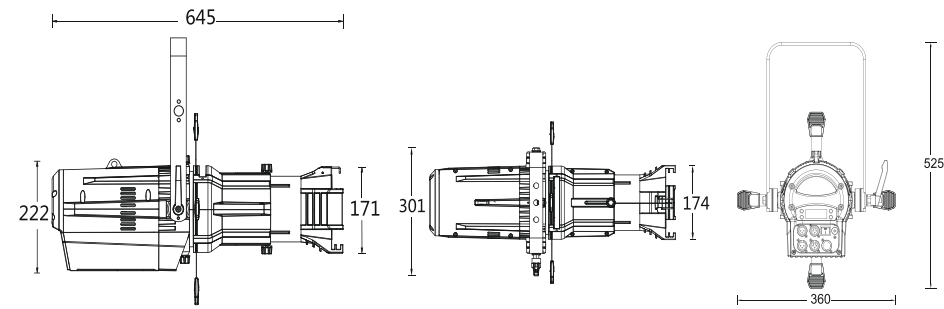

100~240VAC,50/60HZ Input Voltage	Dimmer On-board	0~20Hz Strobe	DMX512 Control Protocol	DMX in/out Power in/out Fixture Connection	0-100%(16-bit) Dimmer	Forced convection Cooling	CE/CETL Certification	0°~45° Operation Temperature
-------------------------------------	--------------------	------------------	----------------------------	--	--------------------------	------------------------------	--------------------------	---------------------------------